

# Welcome to RIT!

---

On behalf of AdvanceRIT and the Council for the Representation & Engagement of Women Faculty (CREW), we would like to welcome you to RIT! Our work is to make faculty feel valued, connected and that they belong at RIT. You were recruited and hired for a reason! We are glad you are here.

Here we have compiled a quick guide to help you get started. Don't forget to check out RIT's new faculty [page](#) as well, as it supplies a more in-depth list of resources available to you!

We look forward to watching your career grow at RIT!



# RIT Campus

The campus offers many unique features which you can explore!

- [Underground Tunnels](#)
- Various [dining options](#)
- Comprehensive [floor plans](#) and [maps](#)



Artesano Bakery



Brick City Café



Global Village  
Cantina & Grill



---

## Benefits

If you are wondering about what sort of benefits and advantages that you will receive below are links to the HR as well as the Employee Assistance Program (EAP).

- [HR Website](#)
- [EAP](#)

# Teaching

For inquiries and support towards teaching check out these links!

- [Innovative Learning Institute \(ILI\)](#): coordinates the development, adoption, and promotion of effective teaching and learning. Also provides opportunities for faculty success through a continuum of professional organizational development programs.
- [Captioning Policy and How-To's](#)
- [myCourses Support](#)



---

# Research

If you are looking for services regarding research and how to get recognition for your work check out these links!

- [Sponsored Research Services](#)
- [Grant Writing Boot Camp](#)
- [Human Subjects Research Office](#)
- [Wallace Library](#)
- [RIT Newsmakers](#)

---

# AdvanceRIT Office

Stop by and see us in the SAU! We are located in the hallway connecting Brick City Café and Artesano Bakery!

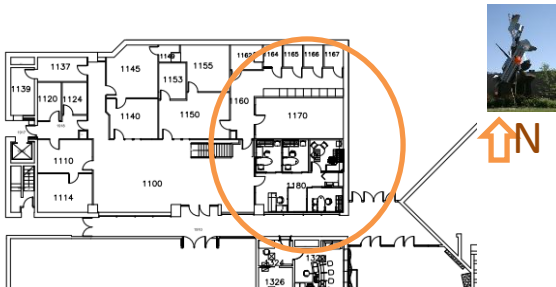

# Support Centers & Services

RIT houses multiple offices and programs that are geared towards supporting their faculty in their professional and personal lives. For anyone who is interested in networking and gaining support check out these programs !

[AdvanceRIT](#): Originally funded through a National Science Foundation ADVANCE Institutional Transformation grant (1209115) with additional support provided by the university, AdvanceRIT is a long-term, multi-faceted program designed to increase and advance women faculty at RIT

[Council for the Representation and Engagement of Women Faculty \(CREW\)](#): is the faculty advisory board to AdvanceRIT. Their mission is to support , retain, and promote career success of women faculty at RIT. Each college has a CREW representative. We encourage you to view the CREW rep profiles on the AdvanceRIT website as they share words of wisdom, their favorite place on campus, research interests and areas where they can provide mentoring to faculty

[Women, Gender, and Sexuality Resource Center](#): committed to promote a campus community that is safe, equitable, and respectful of all members

[Ombuds](#): committed to assisting members of the RIT community with any conflicts or issues they may be having, and provides a safe and confidential place to bring problems, disputes, or questions in a totally confidential manner.

[Title IX Office](#): is responsible for keeping the university in compliance with all Title IX policies

[Faculty Career Development](#) RIT Faculty Career Development Services supports the advancement of faculty throughout their careers at RIT with orientations, mentoring, professional development, and leadership programs. They offer New Faculty Orientation, a Faculty Career Success Series and their website provides resources on topics such as mentoring and free resources for faculty.

