

B E M U

BABY EXAMINATION MOBILE UNIT

The concept of the mobile kangaroo mother care examination Baby Examination Mobile Unit or BEMU is to maximize efficiency and fluidity of doctors, nurses, and clinicians who will be using them to conduct premature infant examinations. The idea behind the bean shape is to address the ergonomic needs of healthcare professionals who are performing these exams multiple times a day. BEMU's softer, organic shape is more fluid in the space and friendlier to the average person's range of motion. The unit can be arranged in different configurations and multiple units form infant examination pods whether inside or outside healthcare units. BEMU is mobile and two units can be nestled together to save space in a smaller environment. Colors from the Hospital Escuela Addition will be brought over into the BEMU to create an overall harmonic identity whether used within the hospital, the mobile education unit or used in a supporting hospital or clinic.

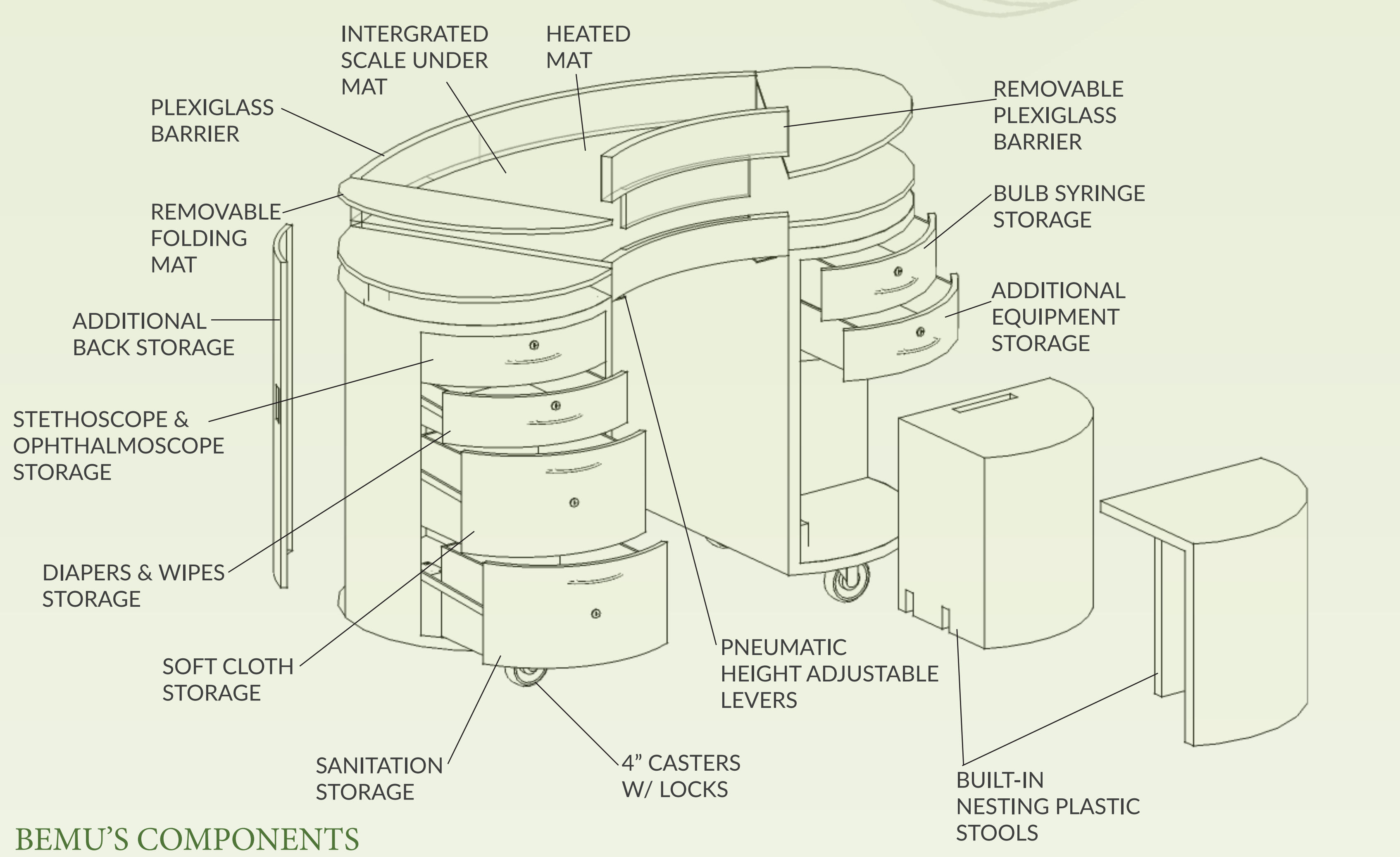
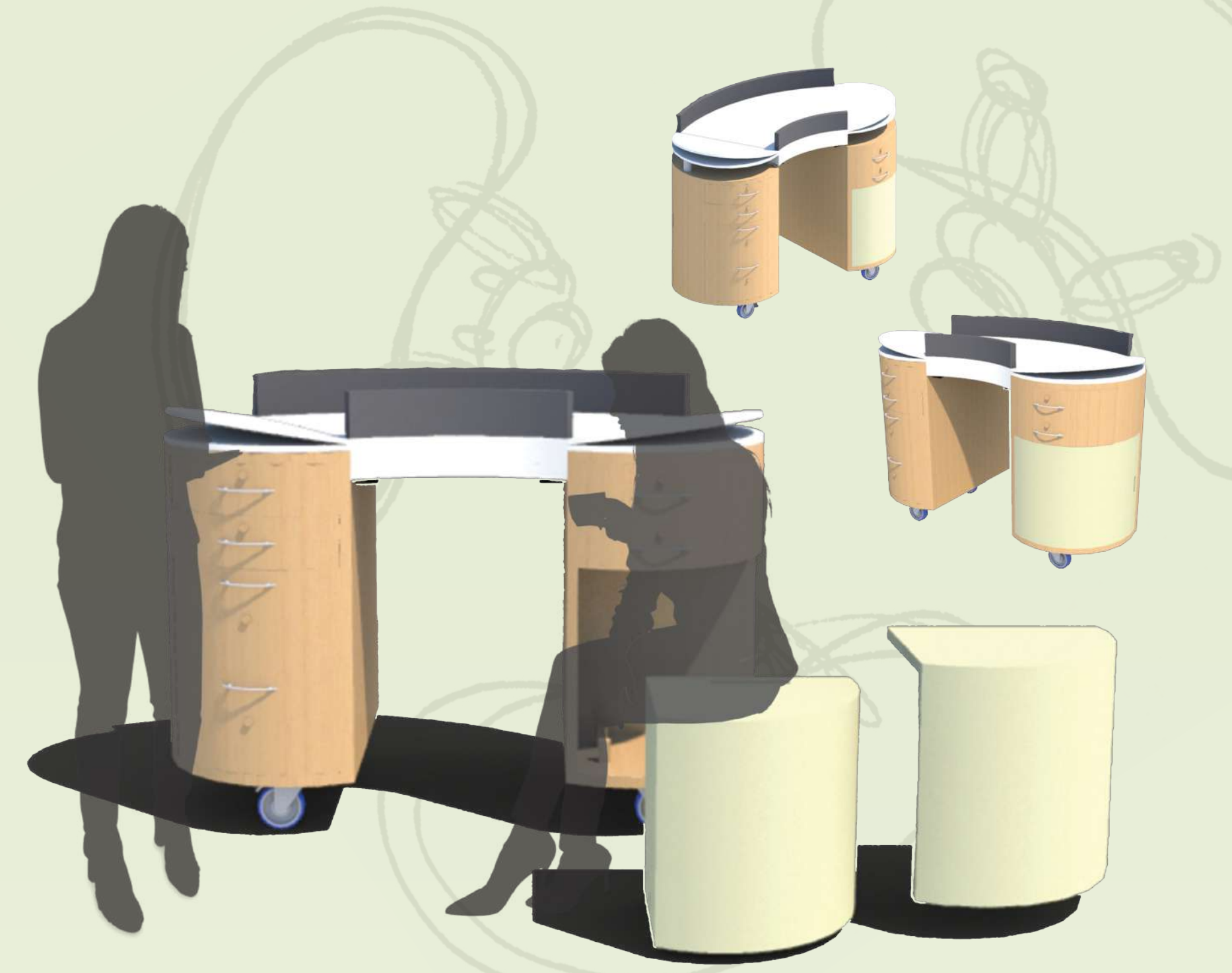

BEMU'S COMPONENTS

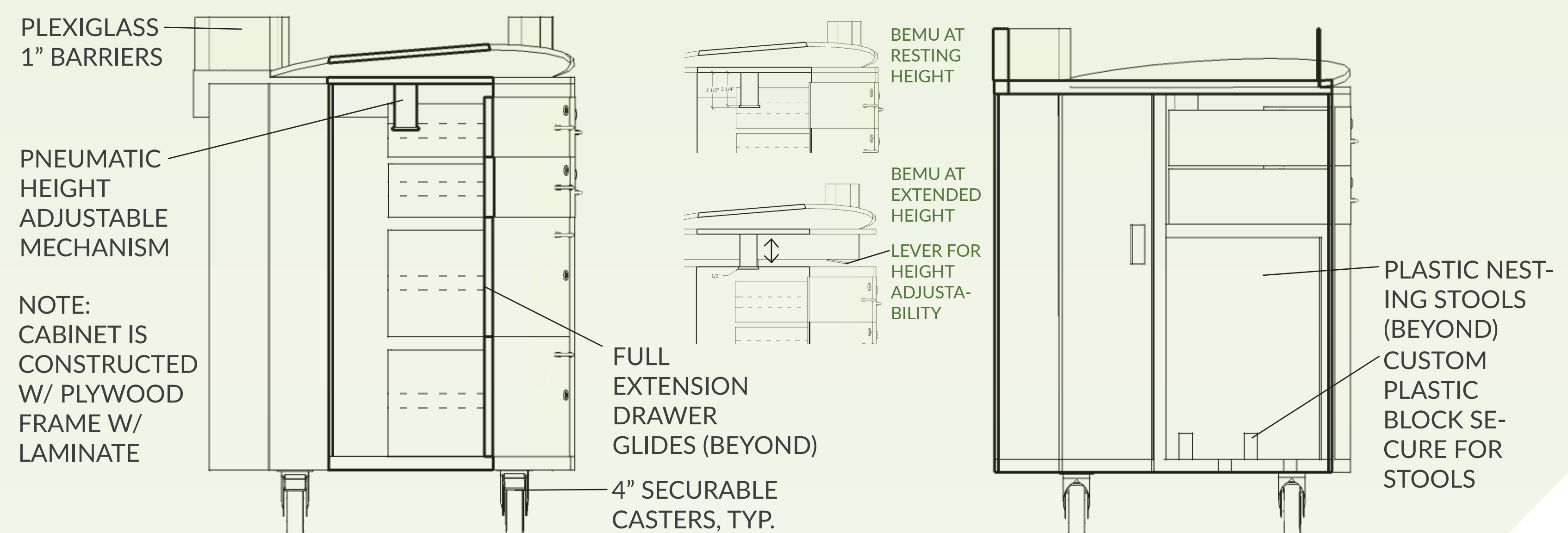

CONCEPTUAL CROSS SECTION DIAGRAMS

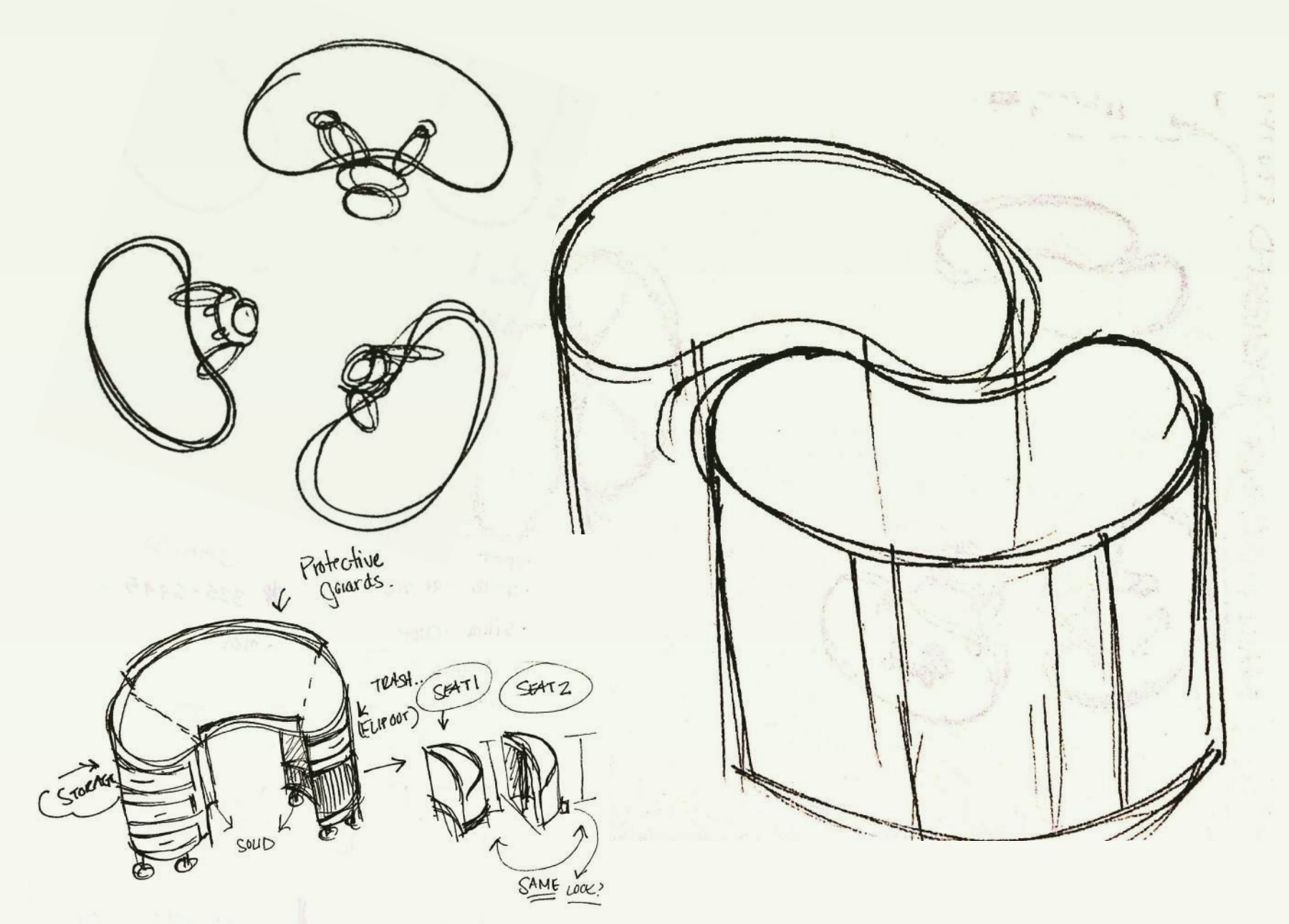

PROCESS SKETCHES

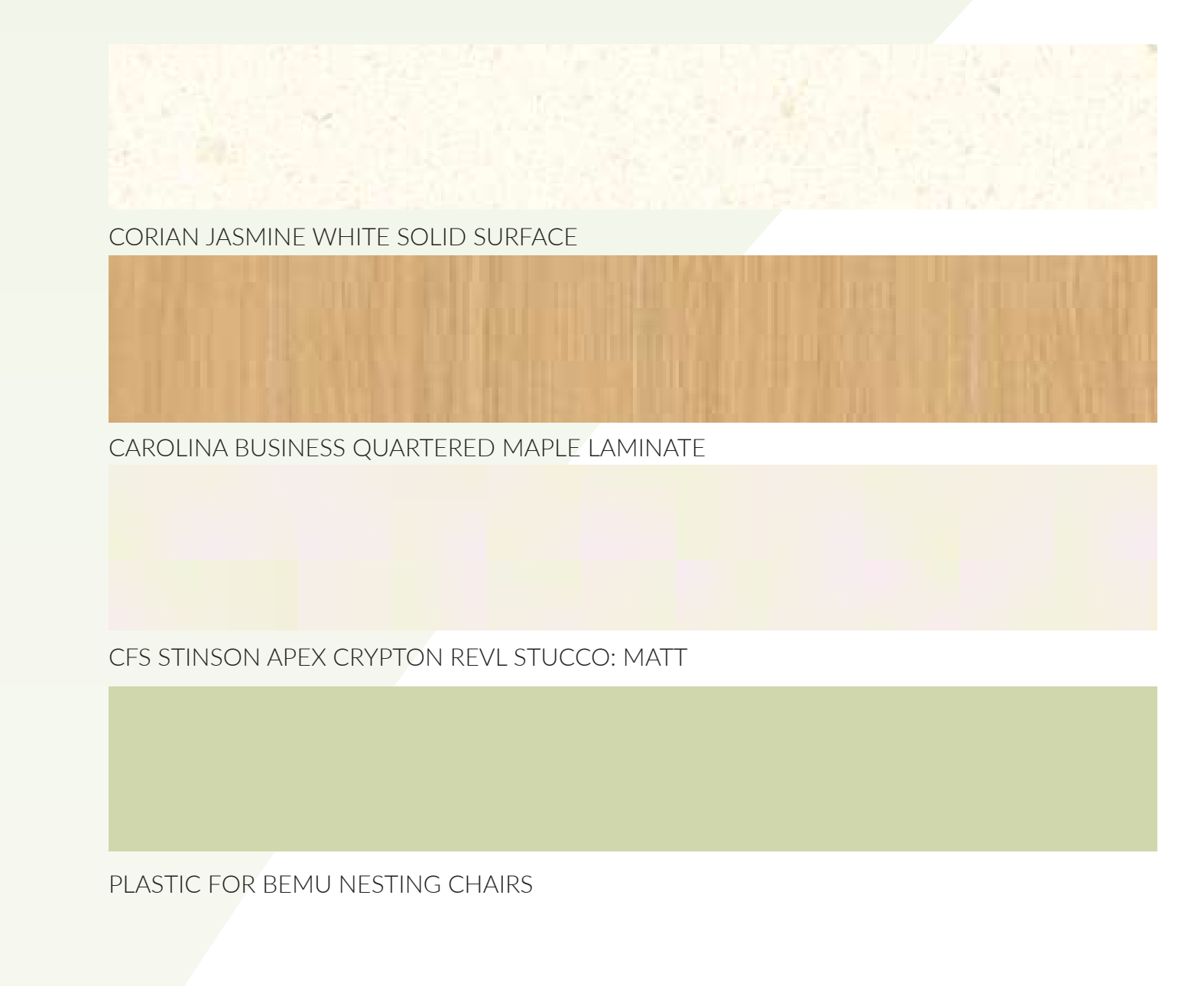

MATERIALITY

