

# SUMMER INSTITUTE + AI Symposium

## DAY 1 SCHEDULE

TUESDAY MAY 14 2024

8:00 - 8:25 AM

### Registration & Breakfast

Premium Continental Breakfast  
Location: SHED, 3rd floor Lobby

8:30 - 9:50 AM

### Opening Remarks

Neeraj Buch, Dean of Undergraduate Studies and Associate Provost for Student Success

### Keynote: Positively Impact Retention, Engagement, Graduation and Employment Outcomes of Neurodivergent Students

Kendra Evans, Director, Spectrum Support Programs, RIT  
Location: SHED, Room 3300

10:00 - 10:50 AM

### Transformative Teaching: A Journey Through Active Learning Strategies

Neeraj Buch  
Wallace 3420

### Integrating LLMs into the Science Curriculum

Christopher Collison (COS),  
Tom Fuller (COS)  
Wallace 3430

### Inclusive Syllabi Design: Strategies for Enhancing Accessibility and Student-Centered Teaching

Nickesia Gordon (CLA)  
Wallace 3440

### Using Projects to Replace Exams

Jennifer O'Neil (CET)  
Wallace 3490

11:00 - 11:50 AM

### Making Time: Prompts and Free Writing in the Classroom

Jessica Pavia (CLA)  
Wallace 3420

### Getting to Know Our Gen Z Students (and Getting Them to Know Us)

Kristin Kant-Byers (CLA)  
Wallace 3430

### PART 1: "Leveling the Playing Field": Cultivating Inclusive Learning Spaces

David Yockel (University Studies),  
mari jaye blanchard (CAD)  
Wallace 3440

12:00 - 12:50 PM

### Lunch

Boxed lunches, and assorted beverages  
Location: SHED, 3rd floor Lobby

1:00 - 1:50 PM

### Tabletop Experiments for Teaching Dynamics in Large Classroom Formats

Mario Gomes (KGCOE)  
Wallace 3420

### Teaching a Gen-AI-Centered Course

Matthew Wright (GCCIS),  
Chris Schwartz (GCCIS)  
Wallace 3430

### PART 2: "Leveling the Playing Field": Cultivating Inclusive Learning Spaces

David Yockel (University Studies),  
mari jaye blanchard (CAD)  
Wallace 3440

### Checking In---Getting to know your students

Raymond Scattone (CLA)  
Wallace 3490

2:00 - 4:00 PM

### Reception & PLIG Poster Showcase

Open bar with cheese and crackers  
Location: SHED, Atrium A-Level

TRACKS: Engaging Learning Experiences ■ Harnessing New Technologies ■ Helping Students Succeed ■

# SUMMER INSTITUTE + AI Symposium

DAY 1 MAPS

TUESDAY MAY 14 2024

## SHED FLOOR 3

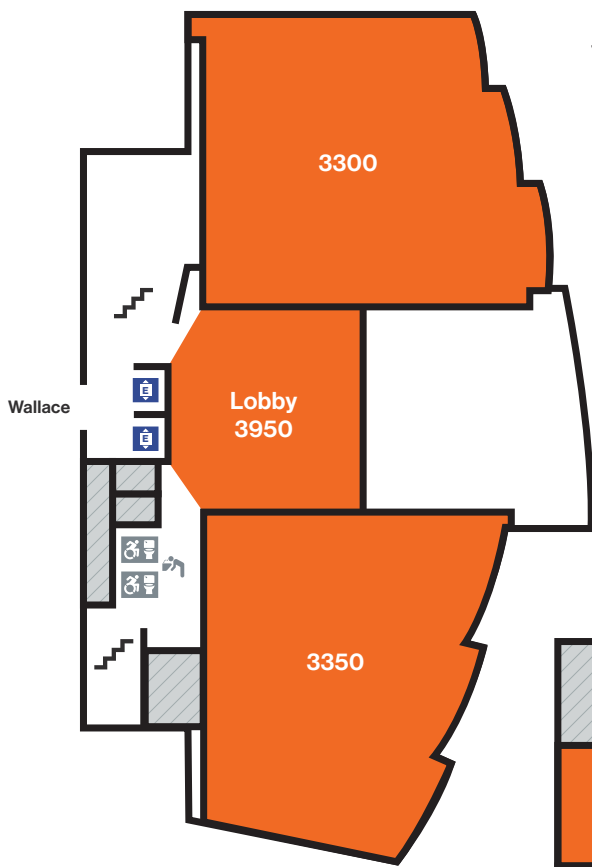

- Event Space
- Non-event Space
- Restricted Access
- Elevator
- Stairs
- Drinking Fountain
- Accessible
- All Gender Restroom
- Men's Women's

## WALLACE FLOOR 3

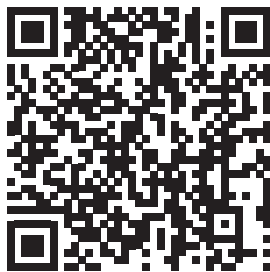

EVENT RESOURCES

# SUMMER INSTITUTE + AI Symposium

## DAY 2 SCHEDULE

WEDNESDAY MAY 14 2024

8:00 - 8:25 AM

### Registration & Breakfast

Continental Breakfast

Location: SHED, 3rd floor Lobby

8:30 - 9:50 AM

### Opening Remarks

David C. Munson Jr. RIT President

Prabu David, Provost and Senior Vice President for Academic Affairs

### Keynote: The Future is Co-Created: Take Student Engagement to the Next Level

Christina Katopodis

Location: SHED, Room 3300

10:00 - 10:50 AM

### Making Active Learning Sweet and Simple!

Emily Coon (COS)

Wallace 3420

### Teaching Hip Hop in a College Classroom

Makini Beck

(CLA & SOIS)

Wallace 3430

### Explore Ethical Generative AI & Test Drive Your AI Prompt

Ihab Mardini (CAD)

Wallace 3440

### Ideation and Collaboration between Humans, More Humans, and AI

Alex Lobos (CAD)

Wallace 3490

11:00 - 11:50 AM

### Novices as Experts: Active Learning in Linked Writing Courses

Phil Shaw (SOIS)

Wallace 3420

### Collaboration and the Art of Compromise

Rebecca Aloisio (CAD),

Mitch Goldstein (CAD)

Wallace 3430

### Think Like AI

Garret Arcoraci (GCCIS),

Robert Kostin (GCCIS)

Wallace 3440

### Generative AI in Art and Design: Teaching Beyond Boundaries

Juan Noguera (CAD)

Wallace 3490

12:00 - 12:50 PM

### Lunch

Boxed lunches, and assorted beverages

Location: SHED, 3rd floor Lobby

1:00 - 1:50 PM

### Embracing Student Mistakes in Teaching

Colin Mathers (CLA)

Wallace 3420

### Transformative Ways to Motivate Students with Joy, Curiosity, and Agency in Learning

Christina Katopodis

Wallace 3430

### Creative Overload: How AI is Supercharging Design Education

Alejandro Perez Sanchez (CAD)

Wallace 3440

### AI Accelerated Curriculum Development & Student Engagement

Shaun Foster (CAD)

Wallace 3490

2:00 - 2:50 PM

### AI Task Force Panel Discussion

Location: SHED, Room 3350

3:00 - 5:00 PM

### Reception & Teaching with AI Demonstrations

Open bar with cheese and crackers

Location: SHED, Atrium A-Level

TRACKS: **Engaging Learning Experiences** ■ **Harnessing New Technologies** ■ **Helping Students Succeed** ■

# SUMMER INSTITUTE + AI Symposium

DAY 2 MAPS

WEDNESDAY MAY 14 2024

## SHED FLOOR 3

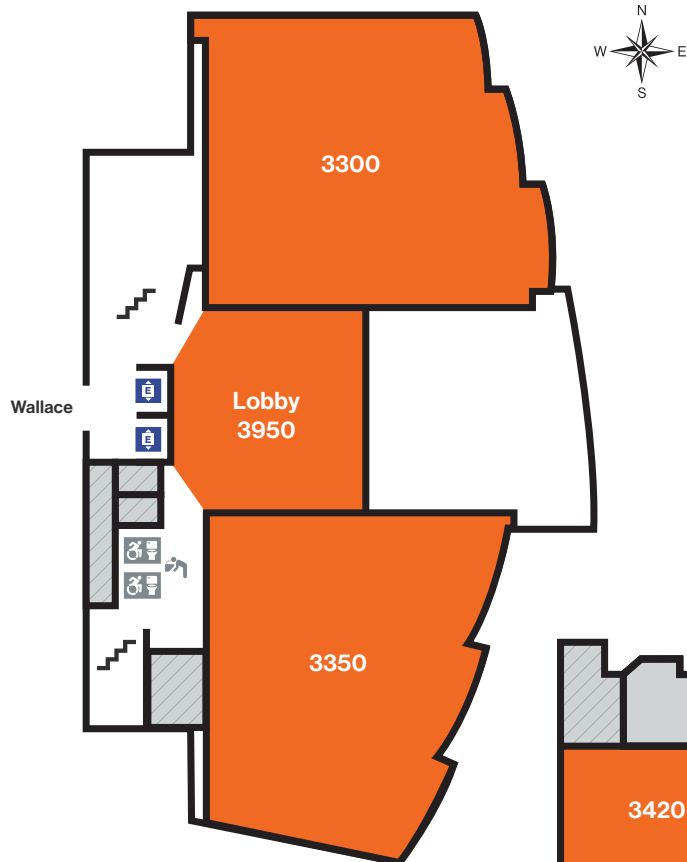

## WALLACE FLOOR 3

